

V9360 Series of Hemispheric Network Dome Cameras

V9360W Outdoor

V9360 Indoor

- 4 megapixel progressive scan CMOS
- Day/night with mechanical IR cut filter
- Minimum illumination 0.06 lux at F2.8
- 180°/360° panorama
- Built-in 1.05 mm / F2.8 megapixel fisheye lens
- 2032 x 1920 maximum resolution
- Selectable H.264, MPEG-4 SP, M-JPEG compressions with dual streaming
- Video motion detection
- ExDR (Extreme Dynamic Range; advanced WDR)
- MicroSD/MicroSDHC card slot for local storage
- Powered by PoE Class 3; 12 VDC
- Indoor and outdoor models; outdoor version has weatherproof IP66 rated housing

360 Degree Vision

The V9360 series provides a high-resolution, hemispherical view of your world that eliminates blind spots and improves long term reliability. Onboard image processing of the 4 megapixel sensor image provides crisp distortion free images. An integral fisheye lens provides an extremely wide angle of view for a panoramic image, capturing a complete 360° view delivered as two 180° images. The image de-morphing is done in the camera itself; this image is then sent as a single stream to the VMS to be used for recording and live view.

Overview

The V9360 provides dual-streaming video and supports H.264 compression technology, drastically reducing file sizes and conserving valuable network bandwidth; MPEG-4 SP and M-JPEG compressions are also supported.

The hemispheric camera series offers indoor and outdoor models. The indoor version is the V9360; the V9360W is designed for outdoor security installations. The camera provides up to 2032 x 1920 resolution. An IR cut filter provides low light sensitivity up to 0.06 lux.

Installation of the V9360 is made easy and cost effective with Power over Ethernet (IEEE 802.3af), which eliminates the need for power cables; 12 VDC is also accepted. A wall mount, V9360-WM, is available for both models; an in-ceiling flush mounting kit, V9360-FMK, is also available for the indoor version.

The camera can be used with many popular VMS systems, including ViconNet®; each VMS may support different camera functions. Using ViconNet, it is possible to digitally zoom in to live or recorded video, providing a close look at any object within the two panoramic views; pixilation is minimal due to the 4MP resolution.

Resolution	Environment	Model Number
2032x1920 pixels (4 megapixel)	Outdoor	V9360W
2032x1920 pixels (4 megapixel)	Indoor	V9360
Mounting Options		
	Indoor/Outdoor	V9360-WM
	Indoor	V9360-FMK

Model	V9360W Outdoor and V9360 Indoor
Camera	
Device Type:	Indoor and outdoor hemispheric cameras
Image Sensor:	1/2.5" progressive scan CMOS
Max Resolution:	2032x1920
Image Settings:	ExDR (extreme dynamic range). Configurable brightness, contrast, saturation. White balance. AGC. Edge enhancement. DNR (2D+3D). Flickerless. Defogging. Motion detection (3-6). Privacy masks (4). Text overlay.
Electronic Shutter Speed:	1/15 - 1/2000 sec (auto mode)
Day/Night Performance:	Day/Night with mechanical IR cut filter
Color to Black&White Switch:	ISP based switch, configurable
IR Sensitivity:	700-1100 nm
Minimum Illumination:	Color: 0.15 fc (1.63 lux); BW: 0.006 fc (0.06 lux) @F/2.8, 30 IRE, 2400° K
Lenses	
Lens:	Fisheye 1.05 mm, F2.8; fixed focus and iris
Angle of View:	Horizontal: 180°
Network Video Transmission	
Network:	10Base-T, 100Base-TX, RJ-45
Image Compression:	H.264, MPEG-4 SP, M-JPEG with dual streaming
Multi-Streaming:	Simultaneous dual streams based on two configurations in single view mode; multiple streams based on single configuration in 6 cropped VGA mode
Max. Frame Rate vs Resolution:	6 fps @2032x1920, 12 fps @1920x1080, 12 fps @1280x720, 12 fps @640x480
Modes:	180°/360° panorama, ePTZ*, 6 VGA*, motion detection preset
Bit Rate:	Constant or Variable; 28 Kbps - 6 Mbps (per stream)
Audio:	8 kHz, Mono, PCM, 16-bit encoding; G.711
Protocols:	IPv6, TCP, UDP, HTTP, RTP, RTSP, NTP, DHCP, SMTP, DDNS, HTTPS, PPPoE, DNS, ICMP, ARP, IGMP, UPnP, SNMP, FTP, Bonjour
Users:	Up to 10 clients
Web Browser:	Internet Explorer® 6.0 and above
Alarms:	Video Motion Detection (up to 6 regions, depending on video mode); external device through digital input
Security:	Password protection, IP address filtering, HTTPS, IEEE 802.1X network access control
Mechanical and Electrical	
Construction:	Outdoor: Die cast aluminum. Indoor: Plastic
Mounting:	2 mounting holes provided
Controls and Connectors:	PoE/Network: RJ-45. Digital Input/Output: 8 pin terminal block (2 of each). Power: 3 pin terminal block. Audio In/Out: phone jacks with cable (indoor); terminal block (outdoor). Micro SD card slot.
Dimensions:	Outdoor: H: 2.3 in. (58.7 mm); D: 6 in. (152 mm). Indoor: H: 1.8 in. (45.3 mm); D: 5.9 in. (150 mm).
Weight:	Outdoor: 1.76 lb (0.8 kg). Indoor: 0.93 lb (0.42 g)
Input Power:	PoE (IEEE 802.3af Class 3); 12 VDC
Current:	Outdoor: 0.8 A. Indoor: 0.64 A
Power Consumption:	Outdoor: 9.6 W. Indoor: 7.68 W
Environmental	
Operating Conditions:	Temp: Outdoor: -22 to 122° F (-30 to 50° C); Indoor: 14 to 122° F (-10 to 50° C). Humidity: 10% - 85%, non-condensing.
Approvals:	FCC Class A, CE. Outdoor: IP66
Warranty:	3 years



- 1 DC 12v Power Input
- 2 Ethernet Port
- 3 Reset Button
- 4 Power Button
- 5 Audio Input / Output
- 6 Digital Input / Output
- 7 Micro SD / Micro SDHC Card Slot

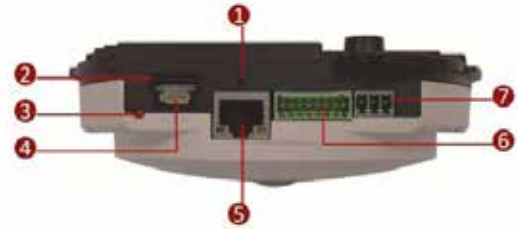

- 1 Reset Button
- 2 Micro SD / Micro SDHC Card Slot
- 3 Power LED
- 4 Audio Input / Output
- 5 Ethernet Port
- 6 Digital Input / Output
- 7 DC 12v Power Input

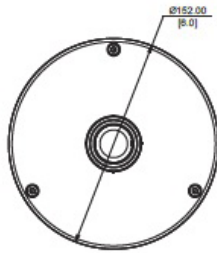

Unit: mm [inch]

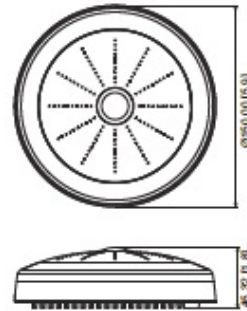

Unit: mm [inch]