

Instruction Manual XX137-10

Introduction

The information in this manual covers the installation and setup of the V910-PH Pendant Housing for the Roughneck V910 Fixed-Position Camera Domes. This unit should be installed by a qualified technician using approved materials in accordance with national, state and local codes. Read these instructions through completely before attempting installation.

The V910-PH provides pendant mounting for the Roughneck V910 Series Fixed-Position Camera Domes. Refer to Installation and Operation Manual XX137 for V910 Camera Dome complete installation instructions. The pendant housing was designed for use with any mount that supports the total weight of the V910 and V910-PH. Refer to Installation and Operation Manual for the selected mount for specific mounting information.

Installation

When the Roughneck V910 Dome Camera requires a pendant configuration, it must be installed in a V910-PH pendant housing. The mounting surface must provide suitable strength to support the weight of the V910 and the V910-PH combined, which is approximately 5 lb (2.3 kg). Be sure the area in the selected location is clear of obstacles (such as steel beams, headers, pipes, electrical wiring, etc.), which would interfere with mounting. Video and power cables must be routed to the location. Follow the steps below and refer to Figures 1 and 2.

1. Install the selected mount using appropriate hardware for the installation surface and run the cables through it according to instruction manual for the mount.
2. Remove the lower dome/trim ring assembly from the base of the V910 by removing the four (4) screws.
3. Install the O ring provided in the accessory kit into the groove in the V910-PH.
4. Align the mounting holes in the base of the V910 with the mounting holes in the V910-PH and secure with the four (4) screws and lockwashers provided in the accessory kit.
5. Run the cables through the access hole in V910-PH and the V910. Be sure to have sufficient cable length to complete wiring.
6. Apply pipe sealant provided to the threads of V910-PH to create a seal. Screw the V910-PH assembly onto the wall mount.
7. Wire the V910 according Figure 2; refer to XX137 for complete instructions if necessary.
8. Continue with the instructions in the Roughneck V910 installation manual for camera configuration.
9. Reattach the lower dome/trim ring assembly.

Copyright © 2005 Vicon Industries Inc. All rights reserved.
Vicon and its logo are registered trademarks of Vicon Industries Inc.
Product specifications subject to change without notice.

VICON INDUSTRIES INC., 89 ARKAY DRIVE, HAUPPAUGE, NEW YORK 11788
TEL: 631-952-CCTV (2288) FAX: 631-951-CCTV (2288) TOLL FREE: 800-645-9116
24-Hour Technical Support: 800-34-VICON (800-348-4266)
UK: +44 (0) 1489 566300 WEB: www.vicon-cctv.com

SVFT-UWM
(wall mount shown as a reference)

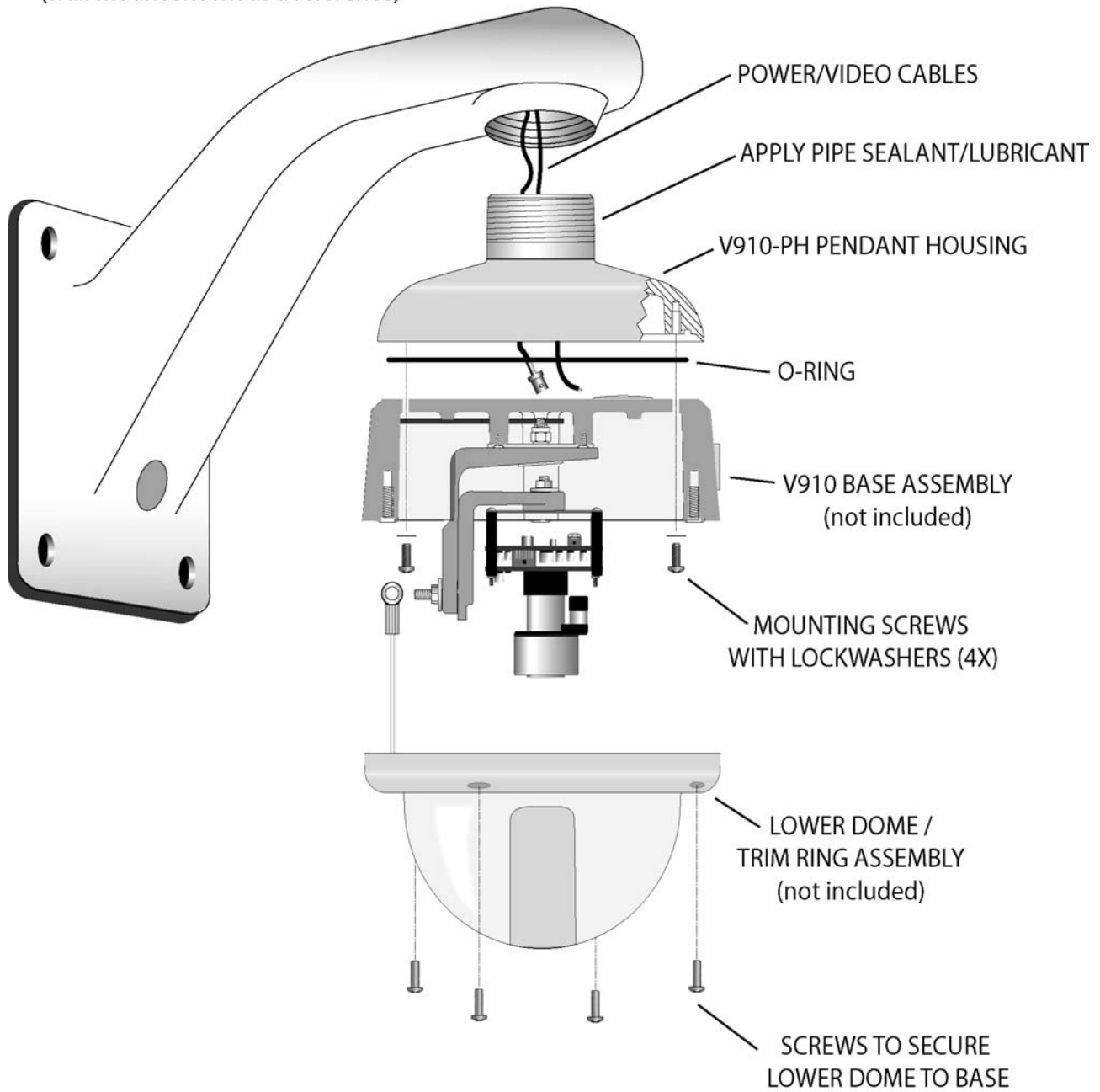
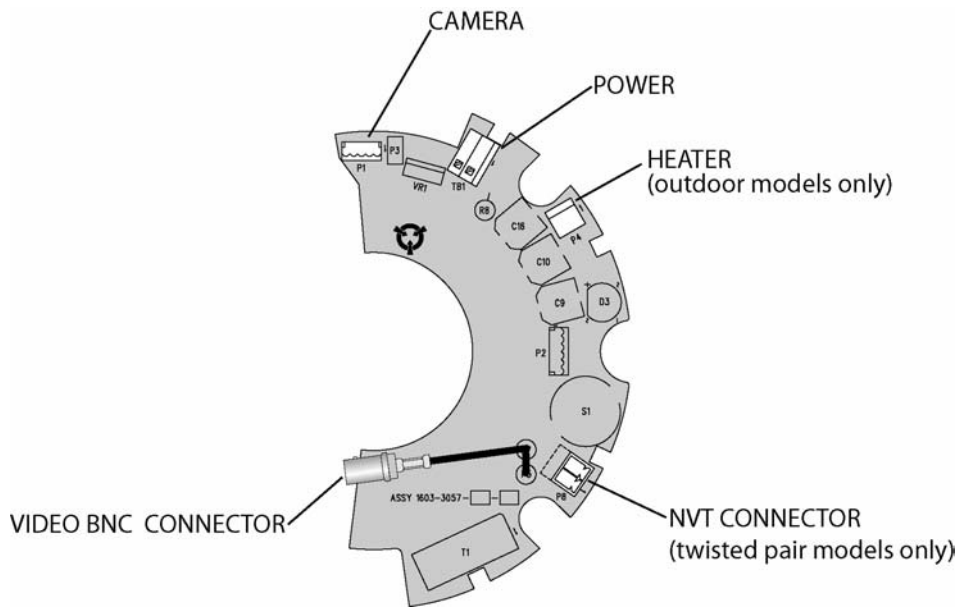
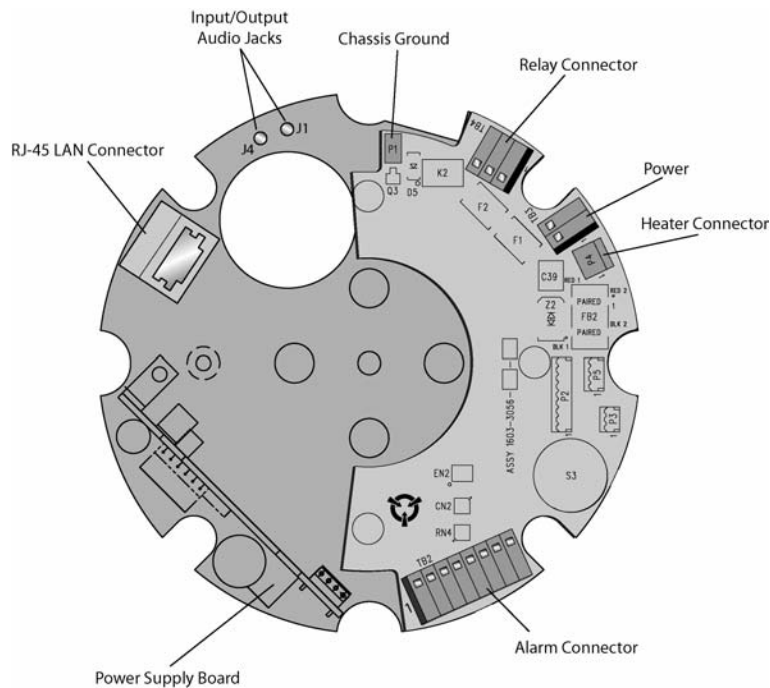

Figure 1
Installation Diagram Exploded View



Coaxial/UTP Versions PC Board



LAN Version PC Board

**Figure 2
Cable Connections**

Vicon Industries Inc.

Corporate Headquarters

89 Arkay Drive
Hauppauge, New York 11788
631-952-CCTV (2288) 800-645-9116
Fax: 631-951-CCTV (2288)

Vicon Europe Headquarters

Brunel Way
Fareham, PO15 5TX
United Kingdom
+44 (0) 1489 566300
Fax: +44 (0) 1489 566322

Brussels Office

Planet II - Unit E
Leuvensesteenweg 542
B-1930 Zaventem
Belgium
+32 (2) 712 8780
Fax: +32 (2) 712 8781

Far East Office

Unit 5, 17/F, Metropole Square
2 On Yiu Street, Shatin
New Territories,
Hong Kong
(852) 2145-7118
Fax: (852) 2145-7117

Internet Address: www.vicon-cctv.com

