

V661V-Series Vandal-Proof Analog Camera Dome Series



- Day/Night and IR illumination models available
- On-screen menus with innovative joystick control make setup and operation easy
- Privacy masking
- 600 TV lines
- 3D Digital Noise Reduction (IR model)
- HLC (High Light Compensation)
- Wall or ceiling mounting
- Easy to install and set up
- IP66 rated

The V661V Series of Outdoor Camera Domes offer a compact, vandal-proof domed housing incorporating a fixed camera and lens combination. They are configured for wall or ceiling mounting. Day/Night and Infrared Illumination (IR) models are offered in NTSC and PAL versions.

Camera and Optics Provide Outstanding Performance and Value

The V661V Series includes a 2.8-12 mm varifocal lens that provides superb sharpness and excellent sensitivity. The Day/Night model also offers a 9-22 mm lens. The cameras utilize a 1/3-inch Sony® Super HAD™II CCD device with a resolution of 600 TV lines.

The IR camera provides advanced 3D digital noise reduction, which significantly reduces motion blur during low light conditions and greatly reduces video noise. This improves image quality, minimizes video interference and triggering of false alarms and provides a better compression ratio, which decreases storage requirements. The day/night camera provides 2D DNR with an ICR filter for excellent performance in low-light conditions.

The cameras provide motion detection, backlight compensation, sidelight compensation and automatic white balance. Digital image stabilization (IR model) provides a stable image in a variety of conditions for excellent recording and playback.

Durable Construction and Easy Installation

The cameras are constructed of die-cast aluminum with a high-impact polycarbonate plastic dome. Tamper-resistant screws make the unit resistant to vandalism. The IP66 rated camera package is designed to withstand the harshest conditions and destructive environments of correctional facilities, warehouses and loading docks. The cameras may be wall or ceiling mounted. Optional accessories are available for pole, corner, in-ceiling and pendant-style mounting. An optional heater accessory extends the low temperature range of the units.

The extensive on-screen display menus allow for set up of white balance, AGC, backlight compensation, exposure, titling, privacy masks and many other functions.

The camera position is adjustable, allowing for adjustment of pan (360°), tilt (90° from vertical) and rotation about its axis (roll/azimuth), for any angle of view required. The lens zoom and focus can be easily adjusted.

Camera and Optics

	Model Numbers	
	V661V-312IR	V661V-312N/V661V-922N
Type:	IR*	Day/Night
Image Device:	1/3-inch Sony Super HAD II CCD	1/3-inch Sony Super HAD II CCD
Picture Elements:	NTSC: 811 (H) x 508 (V), 410,000 pixels PAL: 795 (H) x 596 (V), 470,000 pixels	
Scanning System:	2:1 interlace	
Scanning Frequency:	NTSC: 15.734 KHz (H) x 60 Hz (V) PAL: 15.625 KHz (H) x 50 Hz (V)	
Synchronization:	Internal/ Line Lock	Internal
Shutter Speed:	NTSC: 1/60-1/100,000 sec/PAL: 1/50-1/100,000 sec	
Horizontal Resolution:	600 TV lines color	
Sensitivity:	Color: 0.014 fc (0.14 lux) with f/1.2 lens at 30 IRE B&W: 0.003 fc (0.03 lux) with f/1.2 lens at 30 IRE IR LEDs On: 0 fc (0 lux) with f/1.2 lens at 30 IRE	Color: 0.01 fc (0.1 lux) B&W: 0.004 fc (0.04 lux)
Video Output:	1.0 V p-p @75 ohms, composite	
S/N Ratio:	>50 dB (AGC off, Sense Up off)	>50 dB (AGC off)
Camera Control:	RS-485	N/A
Auto Iris Control:	DC/ELC	DC/Manual
Brightness:	0-99	0-255
Backlight Compensation:	On/Off	Off/BLC/HLC
Automatic Gain Control (AGC):	Selectable: Off, Low, Middle, High	
Dynamic Range:	On/Off (0-20)	D-WDR (On/Off)
Sense Up:	Off/(x2 - x256)	N/A
Digital Noise Reduction:	3D DNR; Selectable: Off, Low, Middle, High.	2D DNR; On/Off
Image Stabilization:	On/Off (Digital Image Stabilization)	N/A
White Balance:	AWC/ATW/Manual/Push	ATW1/ATW2/AWC-Set/Manual
Privacy Mask:	6 programmable zones (polygonal mosaic)	6 programmable zones (16 colors)
Gamma:	User/0.45/0.6/1	CRT/LCD/User (0.05-1.0)
Side Light Compensation:	On/Off (0-50)	Lens Shading On/Off (0-255)
Dead Pixel Compensation:	Off/Auto (White, Black, DPC Level)	Auto
Day/Night Black and White	N/A	Burst: On/Off IR Smart: On/Off IR Level: On/Off
Digital Zoom:	3:1 zoom. D-PTZ support enables pan and tilt functionality within zoomed scene.	N/A

* IR model features IR illumination (30 LEDs) for use in no-light environments. Illuminated distance up to 98.4 feet (30 m).

Data Sheet Number: V236-00
Dated: 1/2012

Vicon Data Sheet Part Number: 8009-7236-00-06
Specifications subject to change without notice.

Vicon and its logo are registered trademarks or trademarks of Vicon Industries Inc.
Sony and Super HAD are registered trademarks or trademarks of Sony Corporation.
Copyright © 2011 Vicon Industries Inc. All rights reserved.

Lens:

Focal Length :	2.8-12 mm	9-22 mm
Aperture:	f/1.2	f/1.4
Field of View:	2.8 mm: 94.2° H 12 mm: 26.2° H	9 mm: 30.7° H 22 mm: 12.5° H

Electrical**Model Numbers**

	V661V-312IR	V661V-312N/V661V-922N
Input Voltage:	12 VDC ±10% or 24 VAC ±10%	
Current:	0.42 A @ 12 VDC max.; 0.35 A @ 24 VAC max.	0.21 A @ 12 VDC max.; 0.2 A @ 24 VAC max.
Power Consumption:	5 W maximum	2.5 W maximum
Connectors:	Power: 2-pin connector Video: BNC on pendant cable RS-485: 2-pin connector	Power: 2-pin connector Video: BNC on pendant cable
Certifications:	UL, CE, FCC, Class A, IP66	

Operational

Control Display:	On-screen, menu-driven system allowing full configuration of the camera.	
Tilt and Horizontal Adjustment:	Pan, 360°; tilt, 90° from vertical and rotation about its axis (roll/azimuth).	
Lens Adjustment:	Focus: focus lever screw Zoom: zoom lever screw	
Motion Detection:	On/Off (Set window, All Set, All Clear, Sensitivity, Show Indicator, Delay Out)	On/Off 4 area selectable
Titling:	On/Off, alphanumeric character set, up to 8 characters	
Effects:	V-Flip/Mirror/Rotate/Neg or Pos/Freeze/Sharpness	Mirror/Neg or Pos/Sharpness/Contrast/ Parking Line

Environmental

Operating Temperature Range:	14 to 131° F (-10 to 55° C) -22 to 131° F (-30 to 55° C) with optional heater
Operating Humidity Range:	Up to 90% relative, non-condensing.

Warranty

3 years parts and labor

Ordering Information





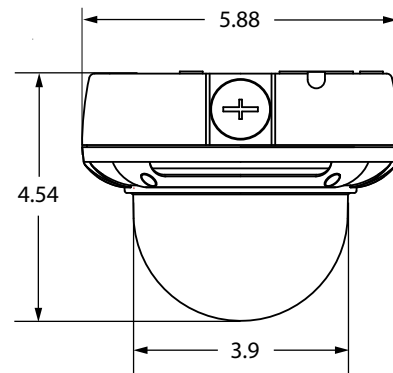

Description	Model Number
IR Vandal-Proof dome camera. 1/3-inch format with DNR and 600 TV line resolution. 12 VDC or 24 VAC.	V661V-312IR
Day/Night Vandal-Proof dome camera. 2.8-12 mm lens, 1/3-inch format with DNR and 600 TV line resolution. 12 VDC or 24 VAC.	V661V-312N
Day/Night Vandal-Proof dome camera. 9-22 mm lens, 1/3-inch format with DNR and 600 TV line resolution. 12 VDC or 24 VAC.	V661V-922N

For PAL models add a -P to the Model Number. For example: V661V-312IR-P.

- Die-cast aluminum construction with polycarbonate plastic dome and black mask. Rated for IP66 ingress protection.
- Wall or ceiling mounting
- Housing Diameter: 5.88 inches (146.4 mm)
- Dome Diameter: 3.9 inches (100 mm)
- Height: 4.54 inches (115.4 mm)
- Weight: 1.54 lb. (0.7 kg)



Mounting Accessories

	Description	Model Number
	In-ceiling mount kit for vandal-proof domes.	V660-HCS254
	Wall-mount arm for camera domes.	V660-HDB243
	Wall/Ceiling mount kit for vandal-proof domes	V660-HVPWCB2
	Corner-mount adapter for vandal-proof domes. Used with V660-HVPWCB2.	V660-HCM150
	Pole-mount adapter for vandal-proof domes. Used with V660-HVPWCB2.	V660-HCM151
	NPT-pipe adapter for vandal-proof domes.	V660-HDA202
	Heater accessory for V660-Series indoor and outdoor camera domes.	V660-HT202VF
	Allows the camera dome to be mounted on a 4 x 4 electrical box with a neat look	V660-TRIM